

Specification

Model : R0060TA/R6060TA

Description: R0060TA: 5000*10, 300pcs 2835 SMD LED, bare board series, 12Vdc, constant voltage, LED flex strip
R6060TA: 5000*10, 300pcs 2835 SMD LED, fill with silica gel series, 12Vdc, constant voltage, LED flex strip

Prepared by : _____

Checked by : _____

Standard Dept : _____

Approved by : _____

Issued Status: Draft Published

Specification

Product Name: LED Flex Strip

Model: R0060TA/R6060TA

R0060TA



R6060TA



Applications

Indoor use only, such as in KTV, shopping mall, cabinet etc. for cove and contour lighting.

Features

1. High luminous efficacy with 2835 SMD LED mounted;
2. Can be cut at the printed marks;
3. UL、CE、UL94V-0、RoHS compliant.

Installation

1. Easy installation with double-sided adhesive tape.
2. Multiple installation and fixing options available with the minimum bending diameter as 5cm [1.96in].

Warranty

3years or 13000 hours, whichever comes first.

Optical and Electrical Parameters:

| P/N | LED Color | Color Temperature(K) | Beam Angle (°) | Luminous Flux (lm/m) | CRI | Luminous Efficacy (lm/W) | Working Voltage (V DC) | Working Current (mA) | | Power (W) | |
|-----------|---------------|----------------------|----------------|----------------------|-----|--------------------------|------------------------|----------------------|---------------|--------------|---------------|
| | | | | | | | | 1m [39.37in] | 5m [196.85in] | 1m [39.37in] | 5m [196.85in] |
| R0060TA-A | Neutral white | 6000 | 115 | 980 | ≥75 | 82 | 12 | 1000 | 4000 | 12 | 48 |
| R0060TA-A | Cold white | 9000 | 115 | 980 | ≥75 | 82 | 12 | 1000 | 4000 | 12 | 48 |
| R6060TA-A | Neutral white | 6000 | 115 | 710 | ≥75 | 59 | 12 | 1000 | 4000 | 12 | 48 |
| R6060TA-A | Cold white | 9000 | 115 | 710 | ≥75 | 59 | 12 | 1000 | 4000 | 12 | 48 |
| R6060TA-C | Neutral white | 6000 | 115 | 339 | ≥75 | 53 | 12 | 530 | 2250 | 6.36 | 27 |

Others:

| P/N | LED Color | Standard Length | | Max. Length | | LED Qty (pcs/ m) | Operating Temperature | | Storage Temperature | | IP Grade |
|-----------|---------------|-----------------|--------|-------------|--------|---------------------|-----------------------|----------|---------------------|----------|----------|
| | | (m) | (in) | (m) | (in) | | (°C) | (°F) | (°C) | (°F) | |
| R0060TA-A | Neutral white | 5 | 196.85 | 5 | 196.85 | 60 | -25~+60 | -13~+140 | -25~+70 | -13~+158 | IP33 |
| R0060TA-A | Cold white | | | | | | | | | | |
| R6060TA-A | Neutral white | | | | | | | | | | |
| R6060TA-A | Cold white | | | | | | | | | | |
| R6060TA-C | Neutral white | | | | | | | | | | IP65 |

Notes:

- ① Testing environment temperature: 25±2°C [77±3.6°F];
- ② The actual data of each single product may differ from above typical data which are subject to change without prior notice;
- ③ The color temperature may vary due to reflection of silica gel for fill with silica gel series. Above CCT belong to bare light CCT.

Profile Drawings:

Unit: mm [in]

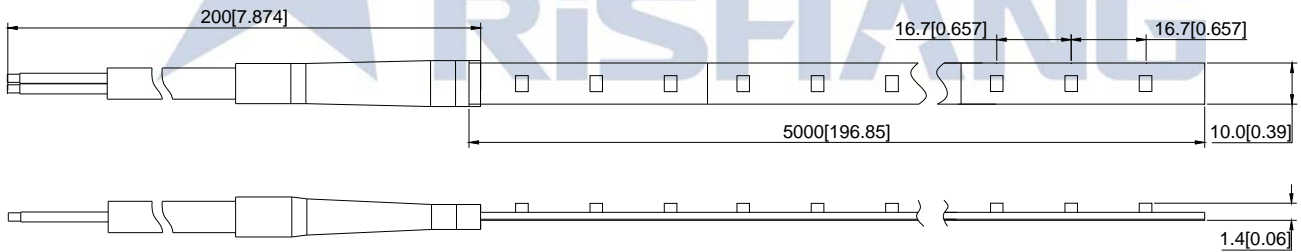

Packaging Diagrams:

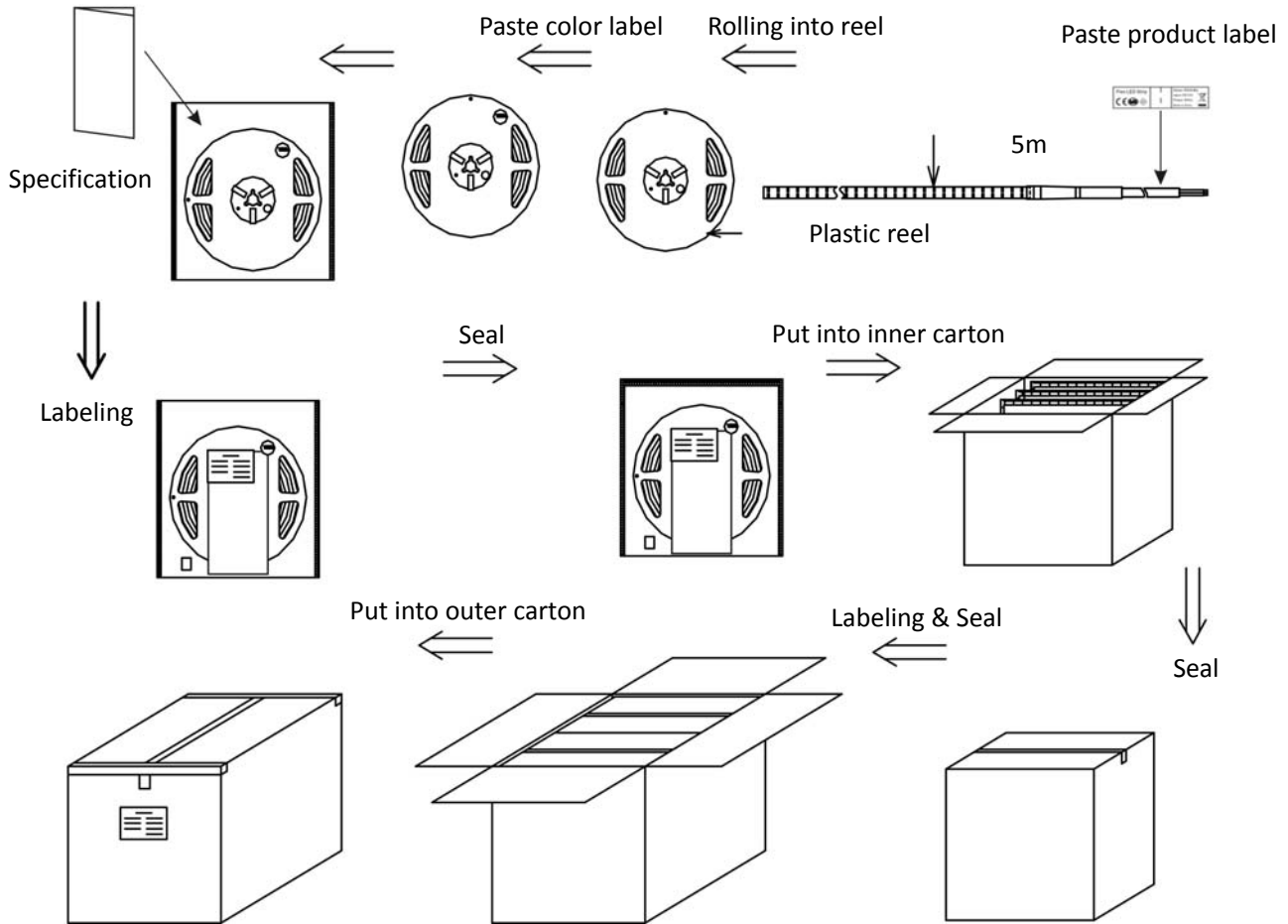

Packaging Information:



R0060TA

1. Rolling this product into plastic reel and then packaged into double-deck corrugated carton.
2. Outer carton: 39.8*25.6*23.8cm =0.0242 (1±10%) CBM [15.66*10.07*9.37n];
3. 5m [196.85in] per reel, 15 reels per inner carton, and 2 inner cartons per outer carton;
4. Net Weight (N.W) : 2.60 (1±10%) kg [5.73 (1±10%) lb];
5. Gross Weight (G.W) : 4.18 (1±10%) kg [9.21 (1±10%) lb];
6. The actual packed quantity and weight may subject to change without prior notice.

R6060TA

1. Rolling this product into plastic reel and then packaged into double-deck corrugated carton.
2. Outer carton: 39.8*25.6*23.8cm =0.0242 (1±10%) CBM [15.66*10.07*9.37n];
3. 5m [196.85in] per reel, 15 reels per inner carton, and 2 inner cartons per outer carton;
4. Net Weight (N.W) : 4.85 (1±10%) kg [10.69 (1±10%) lb];
5. Gross Weight (G.W) :6.43 (1±10%) kg [14.17 (1±10%) lb];
6. The actual packed quantity and weight may subject to change without prior notice.